

Reticle Catalogue

Thermal Scope

THUNDER 2.0 | TQ35 2.0

PANTHER 2.0 | PQ35L 2.0



Reticle 1

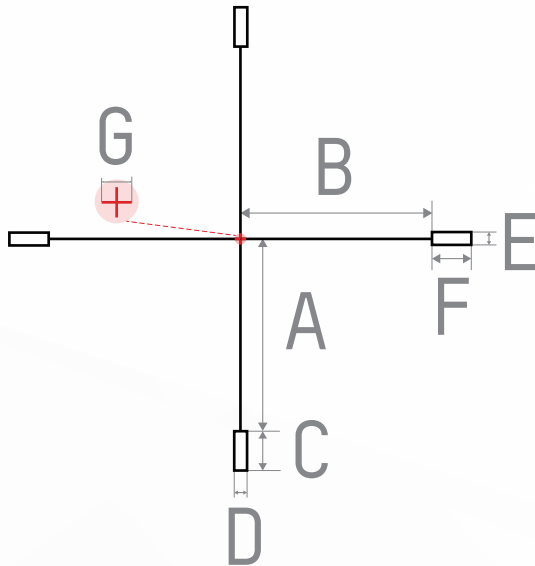

Reticle parameters (for 1x magnification)	MOA	cm@100m
Section A	166.9	485.7
Section B	156.3	454.7
Section C	33.7	98.1
Section D	9.5	27.8
Section E	10.2	29.6
Section F	31.6	91.8
Section G	11.0	31.9

Reticle 2

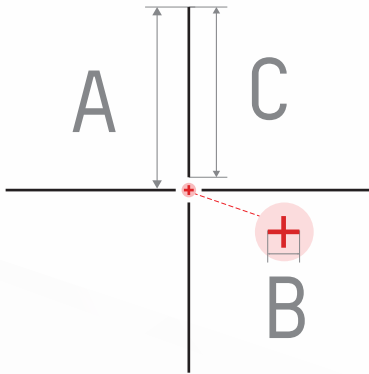

Reticle parameters (for 1x magnification)	MOA	cm@100m
Section A	199.9	581.5
Section B	11.0	31.9
Section C	186.5	542.7

Reticle 3

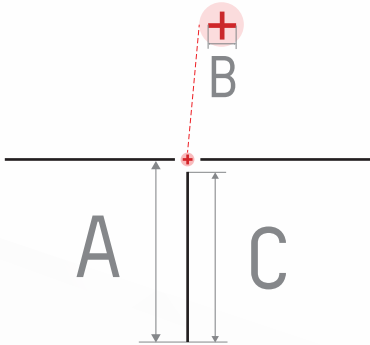

Reticle parameters (for 1x magnification)	MOA	cm@100m
Section A	199.9	581.5
Section B	11.0	31.9
Section C	187.3	545.0

Reticle 4

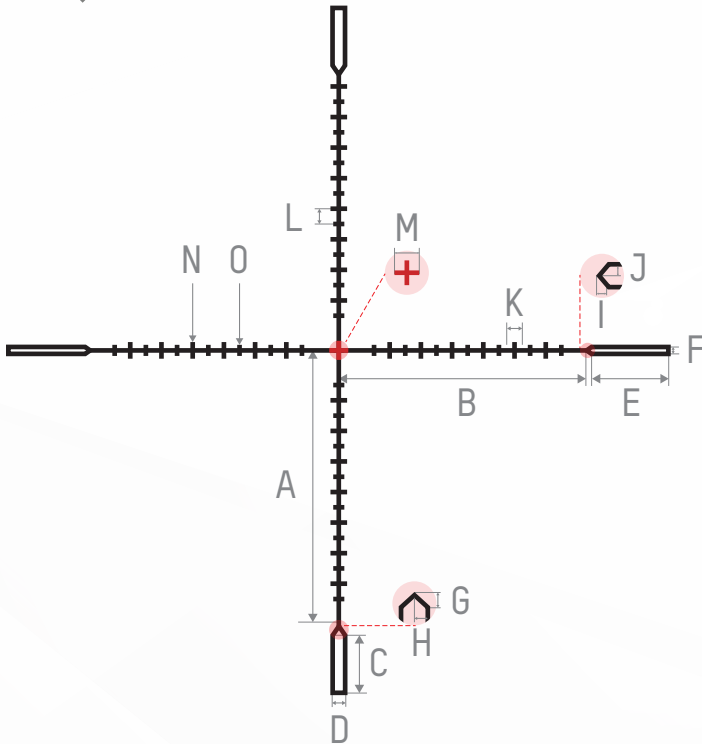

Reticle parameters (for 1x magnification)	MOA	cm@100m
Section A	156.0	453.8
Section B	132.8	386.4
Section C	33.7	98.1
Section D	6.6	19.2
Section E	41.1	119.5
Section F	3.9	11.4
Section G	3.9	11.4
Section H	3.9	11.4
Section I	2.4	6.8
Section J	2.4	6.8
Section K	7.1	20.5
Section L	6.6	19.2
Section M	11.0	31.9
Section N	9.4	27.4
Section O	6.3	18.2

Reticle 5

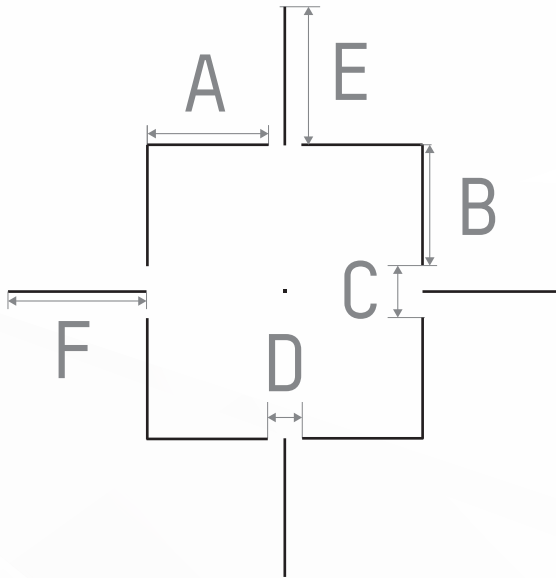

Reticle parameters (for 1x magnification)	MOA	cm@100m
Section A	5.1	14.9
Section B	5.5	16.0
Section C	2.4	6.8
Section D	1.5	4.3
Section E	6.3	18.2
Section F	5.9	17.1

Reticle 6

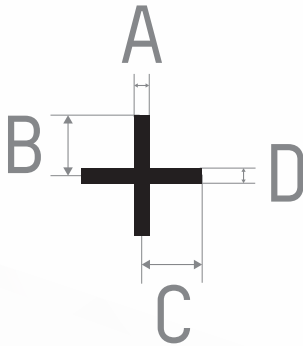

Reticle parameters (for 1x magnification)	MOA	cm@100m
Section A	2.2	6.4
Section B	9.4	27.4
Section C	8.8	25.6
Section D	2.4	6.8

Reticle 7

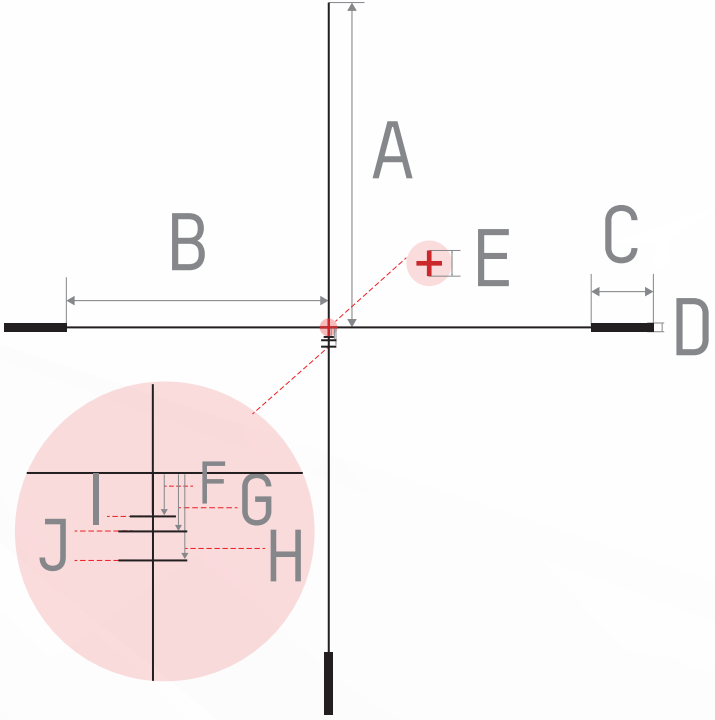

Reticle parameters (for 1x magnification)	MOA	cm@100m
Section A	200.6	583.8
Section B	151.9	441.9
Section C	36.0	104.6
Section D	5.5	16.0
Section E	11.0	31.9
Section F	3.1	9.1
Section G	5.5	16.0
Section H	7.8	22.8
Section I	5.9	17.1
Section J	8.8	25.6

Reticle 8

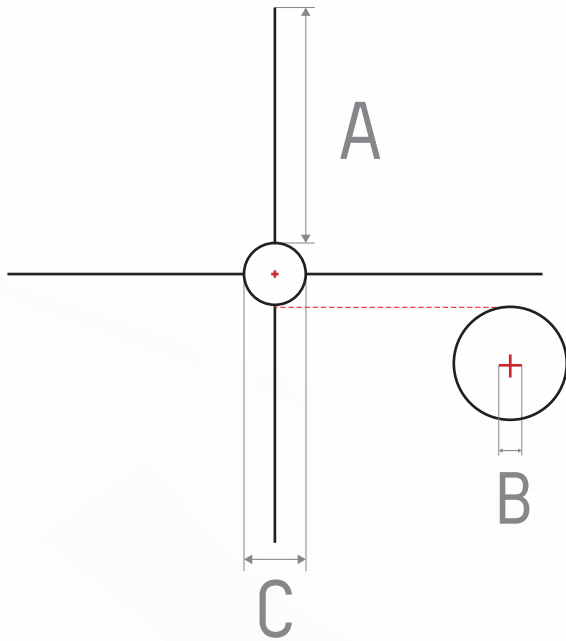

Reticle parameters (for 1x magnification)	MOA	cm@100m
Section A	177.1	515.4
Section B	9.5	27.8
Section C	43.3	125.9

Reticle 9

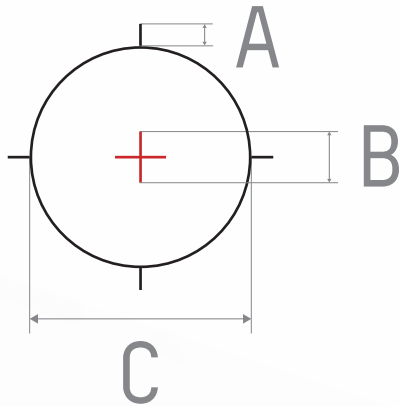

Reticle parameters (for 1x magnification)	MOA	cm@100m
Section A	4.7	13.7
Section B	10.2	29.6
Section C	44.0	128.1

Reticle 10



Reticle parameters (for 1x magnification)	MOA	cm@100m
Section A	8.1	23.5

